

SZ60

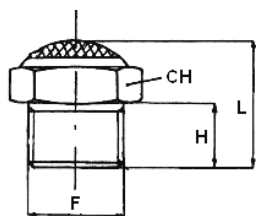

SILENZIATORE CILINDRICO BSPP

SILENCER PARALLEL BSPP

Codice/Code	F	H	L	CH			
SZ6000M5	M5	4	8	8			100
SZ600018	G1/8"	6	14	13			100
SZ600014	G1/4"	7	18	16			100
SZ600038	G3/8	8	19	19			50
SZ600012	G1/2"	10	23	24			50
SZ600034	G3/4	10	24	30			20
SZ600001	G1	12	28	36			10

SZ61

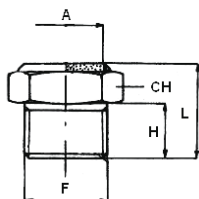

SILENZIATORE CILINDRICO BSPP

SILENCER PARALLEL BSPP

Codice/Code	F	A	H	L	CH		
SZ6100M5	M5	7	5	12	8		100
SZ610018	G1/8"	11	6	14	13		100
SZ610014	G1/4"	14	7	17	16		100
SZ610038	G3/8	17	8	17	19		50
SZ610012	G1/2"	22	10	21	24		50
SZ610034	G3/4	28	10	21	30		20
SZ610001	G1	35	12	21	36		10

SZ62

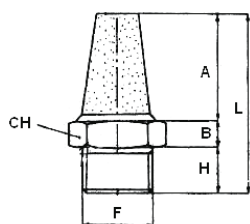

SILENZIATORE CILINDRICO BSPP

SILENCER PARALLEL BSPP

Codice/Code	F	A	B	H	L	CH	
SZ6200M5	M5	9	4	4	17	8	100
SZ620018	G1/8"	15	8	6	27	13	100
SZ620014	G1/4"	17	8	7	32	16	50
SZ620038	G3/8	25	7	8	40	19	20
SZ620012	G1/2"	27	9	9	52	24	20
SZ620034	G3/4	37	10	9	56	30	10
SZ620001	G1	45	10	11	66	36	10

SZ63

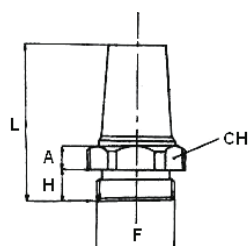

SILENZIATORE CILINDRICO BSPP

SILENCER PARALLEL BSPP

Codice/Code	F	A	H	L	CH		
SZ630018	G1/8	3.8	4.5	24.4	10		100
SZ630014	G1/4	4.5	6	32	14		50
SZ630038	G3/8	5.4	7	36.9	17		20
SZ630012	G1/2	6	8	49.4	22		20
SZ630034	G3/4	7.5	9	47	27		10
SZ630001	G1	9	11	66	36		10

SZ64

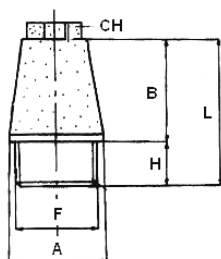

SILENZIATORE CILINDRICO BSPP

SILENCER PARALLEL BSPP

Codice/Code	F	A	B	H	L	CH	
SZ640018	G1/8	11.5	15	4.5	20	8	100
SZ640014	G1/4	15	19	6	25	9	50
SZ640038	G3/8	19	28	7	36	12	20
SZ640012	G1/2	23	33	8	42	16	20
SZ640034	G3/4	30	40	9	50	19	10
SZ640001	G1	37	48	11	62	24	10

SZ73



SILENZIATORE CILINDRICO BSPP

SILENCER PARALLEL BSPP

Codice/Code	F	L	CH				
SZ7300M5	M5						100
SZ730018	G1/8	20	7				100
SZ730014	G1/4	24	8				50
SZ730038	G3/8	36	10				20
SZ730012	G1/2	41	14				20
SZ730034	G3/4						10
SZ730001	G 1						10

SZ65

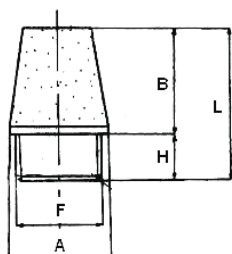

SILENZIATORE CILINDRICO BSPP

SILENCER PARALLEL BSPP

Codice/Code	F	A	B	H	L		
SZ6500M5	M5	6	8.5	4.5	13		100
SZ650018	G1/8	12	15	6	19		100
SZ650014	G1/4	15	19	6	23		50
SZ650038	G3/8	19	28	8	36		20
SZ650012	G1/2	23	33	10	42		20
SZ650034	G3/4	29	40	13	53		10
SZ650001	G1	36	48	15	63		10

SZ66

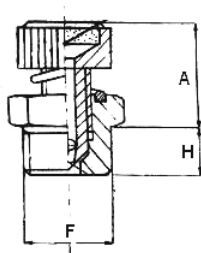

SILENZIATORE CILINDRICO BSPP

SILENCER PARALLEL BSPP

Codice/Code	F	min A	max	H	CH		
SZ660018	G1/8	20	22	6	12		100
SZ660014	G1/4	22	24	8	15		50
SZ660038	G3/8	25	28	10	20		20
SZ660012	G1/2	26	29	11	24		20
SZ660034	G3/4	32	37	12	30		10
SZ660001	G1	32	37	12	36		10

SZ67

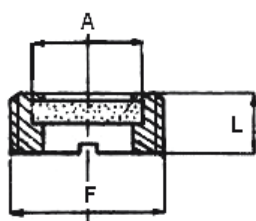

SILENZIATORE CILINDRICO BSPP

SILENCER PARALLEL BSPP

Codice/Code	F	A	L				
SZ670018	G1/8	6	5				100
SZ670014	G1/4	8	7				100
SZ670038	G3/8	10	7				100
SZ670012	G1/2	15	9				100
SZ670034	G3/4	20	9				10
SZ670001	G1	26	10				10

SZ74



SILENZIATORE CILINDRICO BSPP

SILENCER PARALLEL BSPP

Codice/Code	F	L					
SZ740018	G1/8	12					100
SZ740014	G1/4	14					100
SZ740038	G3/8	16					100
SZ740012	G1/2	20					100
SZ740034	G3/4	24					10
SZ740001	G 1	29					10

SZ68

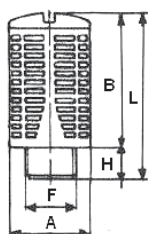

SILENZIATORE DINAMICO CILINDRICO BSPP

SILENCER DYNAMIC PARALLEL BSPP

Codice/Code	F	A	B	H	L		
SZ680018	G1/8	15	27	8	35		100
SZ680014	G1/4	19.5	36	9	45		50
SZ680038	G3/8	24.5	47	11	58		20
SZ690012	G1/2	24.5	47	11	58		20
SZ680034	G3/4	48	96	18	114		10
SZ680001	G1	48	96	18	114		10

SZ69

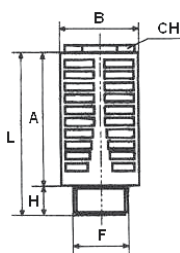

SILENZIATORE STATICO CILINDRICO BSPP

STATIC SILENCER PARALLEL BSPP

Codice/Code	F	A	B	H	L	CH	
SZ690018	G1/8	28	16	6	34	10	100
SZ690014	G1/4	36	19	8	44	12	50
SZ690038	G3/8	46	24	10	56	17	20
SZ690012	G1/2	46	24	10	56	17	20

SZ75



SILENZIATORE CILINDRICO BSPP

SILENCER PARALLEL BSPP

Codice/Code	F						
SZ7500M5	M5						100
SZ750018	G1/8						100
SZ750014	G1/4						50
SZ750038	G3/8						20
SZ750012	G1/2						20
SZ750034	G3/4						10
SZ750001	G 1						10

SX60



SILENZIATORE INOX CILINDRICO BSPP

INOX SILENCER PARALLEL BSPP

Codice/Code	F						
SX6000M5	M5						10
SX600018	G1/8						10
SX600014	G1/4						10
SX600038	G3/8						10
SX600012	G1/2						10
SX600034	G3/4						10
SX600001	G 1						10

SZ70

UGELLO A PETTINE

FLAT NOZZLE



Codice/Code																					
SZ700014																					1

Attacco / Pipe R1/4"

Ingombri / Dimensions 47x90x14,5 (LxDxF)

Temperatura / Temperature -40°C +90°C

SZ71

UGELLO ROTONDO IN PLASTICA

CIRCULAR NOZZLE POLYMER



Codice/Code																					
SZ710014																					1

Attacco / Pipe R1/4"

Ingombri / Dimensions 55x23x10 (LxDxF)

Temperatura / Temperature -40°C +90°C

SZ72

UGELLO ROTONDO IN ALLUMINIO

CIRCULAR NOZZLES ALUMINIUM



Codice/Code	F	L	CH																		
SZ720014	G1/4	33	14																		1

Attacco / Pipe 1/4"

Ingombri / Dimensions 34x19x7,5 (LxDxF)