

DATI TECNICI ACCESSORI STANDARD TEFLONATI TEFLONED STANDARD ACCESSORIES TECHNICAL DATA

Applicazioni
Applications

Pneumatica (idraulica a bassa pressione)
Pneumatic (hydraulic system with low pression)

Materiali
Materials

Corpo Ottone nichelato CW614 N / CW617 N
Body Nickel plated brass CW614 N / CW617 N

Filettatura
Thread types

BSP conica UNI-ISO 7 teflonata.
BSPT taper UNI-ISO 7 with teflon.

Filetti
Threads

Filettature da 1/8" a 3/4"
Threads from 1/8" to 3/4"

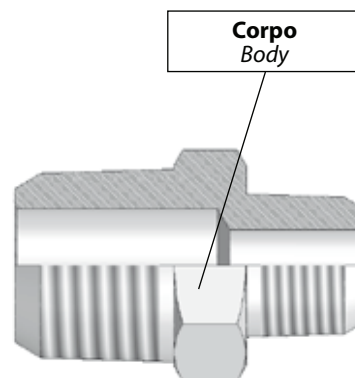

AT52K

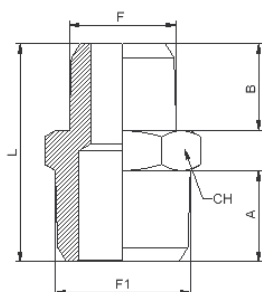

NIPPLO CONICO BSPT TEFLONATO

TEFLONED NIPPLE TAPER BSPT

Codice/Code	F	F1	A	B	L	CH		
AT52K1818	R1/8	R1/8	8	8	20	12		100
AT52K1814	R1/8	R1/4	11	8	24	14		100
AT52K1838	R1/8	R3/8	11.5	8	24.5	17		100
AT52K1414	R1/4	R1/4	11	11	27	14		100
AT52K1438	R1/4	R3/8	11.5	11	27.5	17		100
AT52K1412	R1/4	R1/2	14	11	30.5	22		50
AT52K3838	R3/8	R3/8	11.5	11.5	28	17		100
AT52K3812	R3/8	R1/2	14	11.5	31	22		50
AT52K1212	R1/2	R1/2	14	14	33.5	22		50
AT52K1234	R1/2	R3/4	16.5	14	37.5	27		20
AT52K3434	R3/4	R3/4	16.5	16.5	40	27		20

AT54K

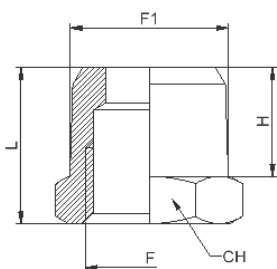

RIDUZIONE MASCHIO-FEMMINA CONICO BSPT TEFLONATO

TEFLONED REDUCER MALE-FEMALE TAPER BSPT

Codice/Code	F1	F	H	L	CH			
AT54K1418	R1/4	G1/8	11	16	14			100
AT54K3818	R3/8	G1/8	11.5	16.5	17			100
AT54K3814	R3/8	G1/4	11.5	16.5	17			100
AT54K1218	R1/2	G1/8	14	19.5	22			50
AT54K1214	R1/2	G1/4	14	19.5	22			50
AT54K1238	R1/2	G3/8	14	19.5	22			50
AT54K3412	R3/4	G1/2	16.5	23.5	27			20

AT55K

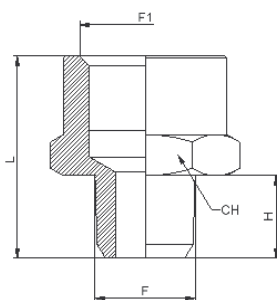

MAGGIORAZIONE MASCHIO-FEMMINA CONICO BSPT TEFLONATO

TEFLONED EXTENSION MALE-FEMALE TAPER BSPT

Codice/Code	F	F1	H	L	CH			
AT55K1818	R1/8	G1/8	8	20	14			100
AT55K1814	R1/8	G1/4	8	22.5	17			100
AT55K1838	R1/8	G3/8	8	25	22			50
AT55K1414	R1/4	G1/4	11	25	17			100
AT55K1438	R1/4	G3/8	11	27	22			50
AT55K1412	R1/4	G1/2	11	31.5	24			50
AT55K3838	R3/8	G3/8	11.5	27.5	22			50
AT55K3812	R3/8	G1/2	11.5	32	26			50
AT55K1212	R1/2	G1/2	14	34,5	26			50

AT60K

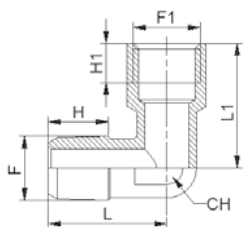
GOMITO MASCHIO-FEMMINA CONICO BSPT TEFLONATO
TEFLONED ELBOW MALE FEMALE TAPER BSPT

Codice/Code	F	F1	H	H1	L	L1	CH	
AT60K0018	R1/8	G1/8	8	7	19	20	10	100
AT60K0014	R1/4	G1/4	12.5	8	24	25.5	13	50
AT60K0038	R3/8	G3/8	13.6	10	26.5	29	17	20
AT60K0012	R1/2	G1/2	15.5	11	31.5	35	20	20

AT62K

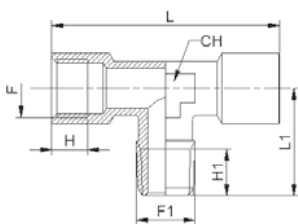
T CENTRALE CONICO BSPT TEFLONATO
TEFLONED CENTRE T MALE TAPER BSPT

Codice/Code	F	F1	H	H1	L	L1	CH	
AT62K0018	G1/8	R1/8	7	8	40	19	10	50
AT62K0014	G1/4	R1/4	8	11	51	24	13	20
AT62K0038	G3/8	R3/8	10	13.6	58	26.5	17	20
AT62K0012	G1/2	R3/8	11	15.5	70	31.5	20	10

AT63K

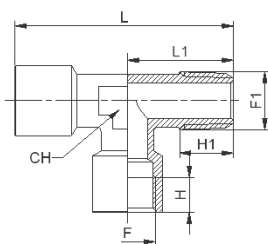
T LATERALE CONICO BSPT TEFLONATO
TEFLONED LATERAL T MALE TAPER BSPT

Codice/Code	F	F1	H	H1	L	L1	CH	
AT63K0018	G1/8	R1/8	7	8	39	19	10	50
AT63K0014	G1/4	R1/4	8	11	49.5	24	13	20
AT63K0038	G3/8	R3/8	10	13.6	55.5	26.5	17	20
AT63K0012	G1/2	R1/2	11	15.5	66.5	31.5	20	10

AT65K

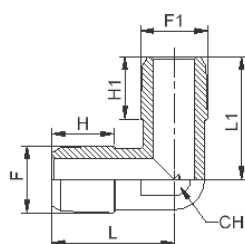
GOMITO MASCHIO CONICO BSPT TEFLONATO
TEFLONED ELBOW MALE TAPER BSPT

Codice/Code	F	F1	H	H1	L	L1	CH	
AT65K0018	R1/8	R1/8	8	8	19	19	10	100
AT65K0014	R1/4	R1/4	12.5	12.5	24	24	13	50
AT65K0038	R3/8	R3/8	13.6	13.6	26.5	26.5	17	20
AT65K0012	R1/2	R1/2	15.5	15.5	31.5	31.5	20	20

AT66K

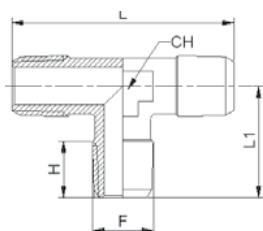

T CONICO BSPT TEFLONATO

TEFLONED T MALE TAPER BSPT

Codice/Code	F	H	L	L1	CH			
AT66K0018	R1/8	8	38	19	10			50
AT66K0014	R1/4	12.5	48	24	13			20
AT66K0038	R3/8	13.6	53	26.5	17			20
AT66K0012	R1/2	15.5	63	31.5	20			10

AT67K

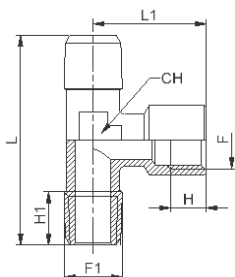

T FEMMINA CENTRALE CONICO BSPT TEFLONATO

TEFLONED CENTRE FEMALE T TAPER BSPT

Codice/Code	F	F1	H	H1	L	L1	CH	
AT67K0018	G1/8	R1/8	7	8	38	20	10	50
AT67K0014	G1/4	R1/4	8	12.5	48	25.5	13	20
AT67K0038	G3/8	R3/8	10	13.6	53	29	17	20
AT67K0012	G1/2	R1/2	11	15.5	63	35	20	10

AT68K

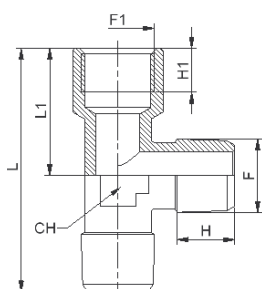

T FEMMINA LATERALE CONICO BSPT TEFLONATO

TEFLONED LATERAL FEMALE T TAPER BSPT

Codice/Code	F	F1	H	H1	L	L1	CH	
AT68K0018	R1/8	G1/8	8	7	39	20	10	50
AT68K0014	R1/4	G1/4	12.5	8	49.5	25.5	13	20
AT68K0038	R3/8	G3/8	13.6	10	55.5	29	17	20
AT68K0012	R1/2	G1/2	15.5	11	66.5	35	20	10