

## DATI TECNICI DEI RACCORDI A CALZAMENTO IN OTTONE BRASS QUICK FITTINGS TECHNICAL DATA

<b>Fluido</b> <i>Fluid</i>	<b>Aria compressa, acqua (altri fluidi a richiesta)</b> <i>Compressed air, water (other fluids on request)</i>			
<b>Applicazioni</b> <i>Applications</i>	<b>Pneumatica (idraulica a bassa pressione)</b> <i>Pneumatic (hydraulic systems with low pression)</i>			
<b>Temperature e pressioni</b> <i>Pression and temperature</i>	<b>Le temperature e le pressioni dipendono dalle caratteristiche del tubo impiegato.</b> <i>Pressions and temperatures depend on tube features.</i>			
<b>Tubi consigliati</b> <i>Recommended tubes</i>	<b>1)Poliuretano</b> <i>1)Polyurethane</i>	<b>2)Poliammide</b> <i>2)Polyamide</i>	<b>3)Polietilene</b> <i>3)Polyethylene</i>	<b>4)Nylon</b> <i>4)Nylon</i>
<b>Tolleranze</b> <i>Tolerances</i>	<b>+/- 0.10 mm</b>			
<b>Materiali</b> <i>Materials</i>	<b>Corpo</b> <i>Body</i>	<b>Ottone nichelato CW614 N / CW617 N</b> <i>Nickel plated brass CW614 N / CW617 N</i>		
	<b>Dado</b> <i>Nut</i>	<b>Ottone nichelato CW614 N / CW617 N</b> <i>Nickel plated brass CW614 N / CW617 N</i>		
<b>Filettatura</b> <i>Thread types</i>	<b>BSP cilindrica UNI-ISO228.</b> <i>BSPP cylindric UNI-ISO228.</i> <b>BSP conica UNI-ISO 7.</b> <i>BSPT conic UNI-ISO 7.</i> <b>Metrica ISO/R 262.</b> <i>Metric ISO/R 262.</i>			
<b>Diametri e filetti</b> <i>Threads and diameters</i>	<b>Diametri da 4 mm a 15mm</b> <i>Diameters from 4 mm to 15 mm</i> <b>Filettature da M5 a 1/2"</b> <i>Threads from M5 to 1/2"</i>			

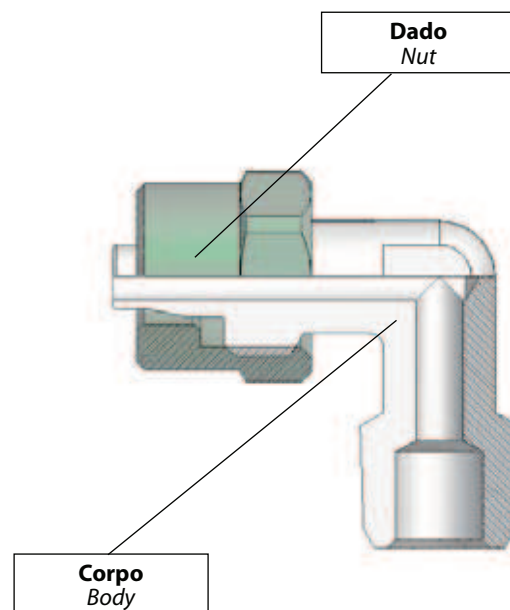

### RC50KG



NEW

#### DIRITTO GIREVOLE MASCHIO CONICO BSPT STRAIGHT MALE ROTATING BODY TAPER BSPT

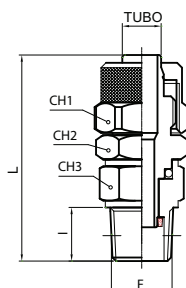

Codice/Code	D	F	I	H	CH1	CH2	CH3	
RC50KG1806	6/4	R1/8	8	37	12	12	13	10
RC50KG1406	6/4	R1/4	11	40	12	14	15	10
RC50KG1808	8/6	R1/8	8	37	14	12	13	10
RC50KG1408	8/6	R1/4	11	40	14	14	17	10
RC50KG1410	10/8	R1/4	11	42	16	14	15	10
RC50KG3812	12/10	R3/8	11,5	43	18	19	17	10

### RC50G



NEW

#### DIRITTO GIREVOLE MASCHIO CILINDRICO CON O-RING BSPP STRAIGHT MALE ROTATING BODY PARALLEL BSPP WITH O-RING

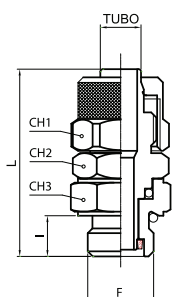

Codice/Code	D	F	I	H	CH1	CH2	CH3	
RC50G1806	6/4	G1/8	6	33	12	12	13	10
RC50G1406	6/4	G1/4	8	35	12	14	16	10
RC50G1808	8/6	G1/8	6	33	14	12	13	10
RC50G1408	8/6	G1/4	8	35	14	14	16	10
RC50G1410	10/8	G1/4	8	37	16	14	16	10
RC50G3812	12/10	G3/8	9	42	18	19	18	10

### RC51K



#### DIRITTO MASCHIO CONICO BSPT MALE STRAIGHT TAPER BSPT

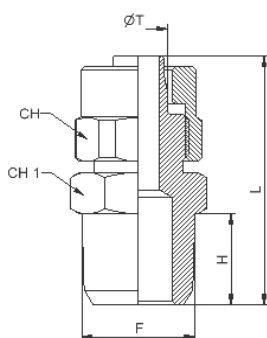

Codice/Code	ØT	F	H	L	CH	CH1	
RC51K1804	4/2	R1/8	8	23.8	8	12	100
RC51K1805	5/3	R1/8	8	25	9	12	100
RC51K1806	6/4	R1/8	8	26.5	12	12	100
RC51K1406	6/4	R1/4	11	30	12	14	100
RC51K3806	6/4	R3/8	10.5	31	12	17	100
RC51K1808	8/6	R1/8	8	26.5	14	12	100
RC51K1408	8/6	R1/4	11	30	14	14	100
RC51K3808	8/6	R3/8	10.5	31	14	17	100
RC51K1208	8/6	R1/2	14	34.5	14	22	50
RC51K1810	10/8	R1/8	8	28	16	14	50
RC51K1410	10/8	R1/4	10.5	32	16	14	50
RC51K3810	10/8	R3/8	11.5	32.5	16	17	50
RC51K1210	10/8	R1/2	14	36	16	22	50
RC51K3812	12/10	R3/8	11.5	35.5	18	17	50
RC51K1212	12/10	R1/2	14	38.5	18	22	50
RC51K1215	15/12,5	R1/2	14	40	22	22	20

**RC51**

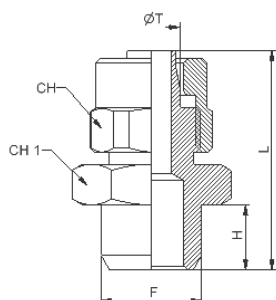

**DIRITTO MASCHIO CILINDRICO BSP**

**MALE STRAIGHT PARALLEL BSPP**

Codice/Code	ØT	F	H	L	CH	CH1		
RC511805	5/3	G1/8	6.5	24	9	14		50
RC511806	6/4	G1/8	6.5	26	12	14		100
RC511406	6/4	G1/4	9	29	12	16		100
RC513806	6/4	G3/8	9	29	12	19		50
RC511808	8/6	G1/8	6.5	26	14	14		100
RC511408	8/6	G1/4	8	27	14	17		100
RC513808	8/6	G3/8	9	29	14	19		100
RC511810	10/8	G1/8	6.5	26	14	16		50
RC511410	10/8	G1/4	9	31	16	16		50
RC513810	10/8	G3/8	9	31	16	19		50
RC511210	10/8	G1/2	10	32	16	24		50
RC513812	12/10	G3/8	9	32	18	19		50
RC511212	12/10	G1/2	10	33,5	18	24		50
RC511215	15/12,5	G1/2	10	35,5	22	24		20

**RC51OR**



**NEW**

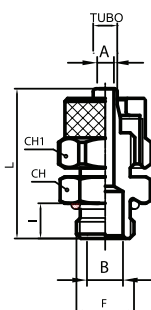

**DIRITTO MASCHIO CILINDRICO CON O-RING**

**MALE STRAIGHT PARALLEL WITH O-RING**

Codice/Code	ØT	F	H	L	CH	CH1		
RC51OR1804	4/2,7	1/8	6	21,8	13	8		50
RC51OR1805	5/3	1/8	6	23	15	8		50
RC51OR1806	6/4	1/8	6	25,5	13	12		100
RC51OR1406	6/4	1/4	8	28	16	12		100
RC51OR3806	6/4	3/8	9	29	19	12		20
RC51OR1206	6/4	1/2	10	30,5	24	12		20
RC51OR1808	8/6	1/8	6	25,5	14	14		100
RC51OR1408	8/6	1/4	8	28	16	14		100
RC51OR3808	8/6	3/8	9	29	19	14		50
RC51OR1208	8/6	1/2	10	30,5	24	14		50
RC51OR1810	10/8	1/8	6	27,5	14	16		50
RC51OR1410	10/8	1/4	8	29,5	16	16		50
RC51OR3810	10/8	3/8	9	30,5	19	16		50
RC51OR1210	10/8	1/2	10	32	24	16		50
RC51OR3812	12/10	3/8	9	32	19	18		20
RC51OR1212	12/10	1/2	10	33,5	24	18		20
RC51OR1215	15/12,5	1/2	10	35,5	24	22		20

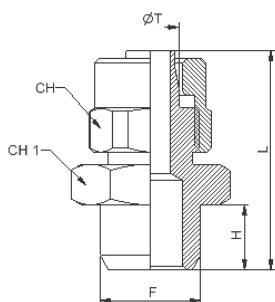
**RC51M**

**DIRITTO MASCHIO METRICO BSPP**
**MALE STRAIGHT METRIC BSPP**

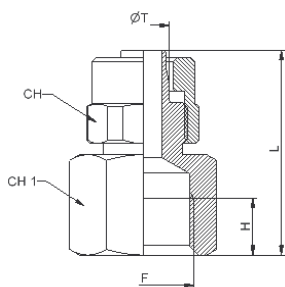
Codice/Code	ØT	F	H	L	CH	CH 1		
RC51M505	5/3	M5	4	20	8	8		50
RC51M605	5/3	M6	5	21	8	8		50
RC51M506	6/4	M5	4	21	9	8		50
RC51M606	6/4	M6	5	22	9	8		50
RC51M12256	6/4	M12X1.25	8	28	12	17		50
RC51M12506	6/4	M12X1.50	8	28	12	17		50
RC51M12258	8/6	M12X1.25	8	28	14	17		50
RC51M12508	8/6	M12X1.50	8	28	14	17		50

**RC52**

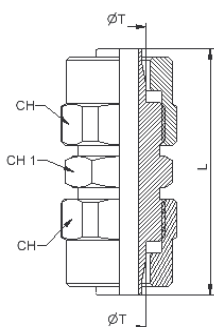
**FEMMINA DIRITTO CILINDRICO BSPP**
**FEMALE STRAIGHT PARALLEL BSPP**

Codice/Code	ØT	F	H	L	CH	CH 1		
<b>NEW</b> RC521804	4/2,7	G1/8	8	21,3	8	14		50
RC521805	5/3	G1/8	8	22.5	8	14		50
RC521806	6/4	G1/8	9	26	12	14		100
RC521406	6/4	G1/4	8	27.5	12	17		100
RC523806	6/4	G3/8	10	29.5	12	20		50
RC521808	8/6	G1/8	9	26	14	14		100
RC521408	8/6	G1/4	8	27.5	14	17		100
RC523808	8/6	G3/8	10	29.5	14	20		50
RC521810	10/8	G1/8	8	26.5	14	16		50
RC521410	10/8	G1/4	10	26	16	16		50
RC523810	10/8	G3/8	10	31	16	20		50
RC521210	10/8	G1/2	11.5	34.5	16	24		50
RC523812	12/10	G3/8	10	32.5	18	20		50

**RC53**

**DIRITTO INTERMEDIO**
**STRAIGHT INTERMEDIATE**

Codice/Code	ØT	L	CH	CH 1				
<b>NEW</b> RC530004	4/2,7	26	8	8				100
RC530005	5/3	28.5	8	8				100
RC530006	6/4	34.5	12	12				100
RC530008	8/6	35	14	14				100
RC530010	10/8	38	16	14				50
RC530012	12/10	41	18	17				50
RC530015	15/12,5	45.5	22	22				20

RC54

PASSALAMIERA

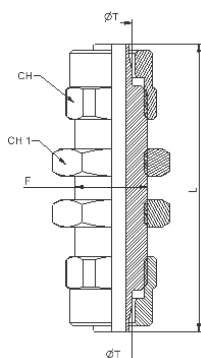
UNION BULKHEAD



Codice/Code	ØT	F	L	CH	CH1		
<b>NEW</b> RC540004	4/2,7	M8x1	36,7	8	9		100
RC540005	5/3	M8x1	40	8	9		100
RC540006	6/4	M10x1	48	12	14		100
RC540008	8/6	M12x1	48	14	16		50
RC540010	10/8	M14x1	54	16	17		50
RC540012	12/10	M16x1	53	18	19		20
RC540015	15/12,5	M20x1	58	22	24		20

RC55K

GOMITO MASCHIO CONICO BSPT

ELBOW MALE TAPER BSPT

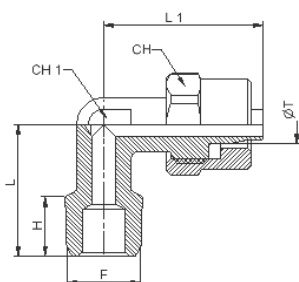

Codice/Code	ØT	F	H	L	L1	CH	CH1	
RC55K1804	4/2,7	R1/8	8	17	19.5	8	8	100
RC55K1805	5/3	R1/8	8.5	17	20.5	9	8	100
RC55K1806	6/4	R1/8	8.5	17	20.5	12	8	100
RC55K1406	6/4	R1/4	12.5	21	20.5	12	8	100
RC55K3806	6/4	R3/8	11.5	28	29	12	11	50
RC55K1808	8/6	R1/8	8	17	20.5	14	10	100
RC55K1408	8/6	R1/4	12.5	21	20.5	14	10	100
RC55K3808	8/6	R3/8	11.5	29	31	14	11	50
RC55K1810	10/8	R1/8	8	24	32	16	10	50
RC55K1410	10/8	R1/4	11	27	32	16	12	50
RC55K3810	10/8	R3/8	11.5	29	32	16	11	50
RC55K1210	10/8	R1/2	14	28	28	16	17	50
RC55K1412	12/10	R1/4	11	24	30	18	14	20
RC55K3812	12/10	R3/8	14	26	29	18	14	20
RC55K1212	12/10	R1/2	14	28	30.5	18	17	20
RC55K1215	15/12,5	R1/2	14	28	34	22	17	20

RC55M

GOMITO MASCHIO METRICO

METRIC ELBOW MALE

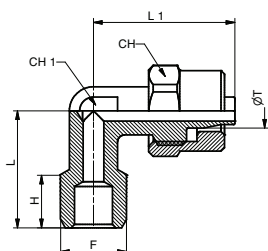

Codice/Code	ØT	F	H	L	L1	CH	CH1	
<b>NEW</b> RC55M504	4/2,7	M5	4	15	19.5	8	8	50
<b>NEW</b> RC55M604	4/2,7	M6	4	15	19.5	8	8	50
RC55M505	5/3	M5	4	15	21.5	8	8	50
RC55M506	6/4	M5	4	15	22.5	9	8	50
RC55M12256	6/4	M12X1.25	9	21	22.5	12	10	50
RC55M12506	6/4	M12X1.50	9	21	22.5	12	10	50
RC55M12258	8/6	M12X1.25	9	21	22.5	14	10	50
RC55M12508	8/6	M12X1.50	9	21	22.5	14	10	50

### RC55OR

#### GOMITO MASCHIO GIREVOLE CON O-RING CILINDRICO BSPP

#### ELBOW MALE (ROTATING BODY) WITH O-RING PARALLEL BSPP

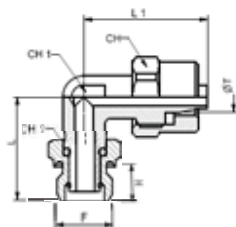

NEW

Codice/Code	ØT	F	H	L	L1	CH	CH1	CH2	
RC55OR1804	4/2,7	G1/8	6	22.5	21.5	12	8	14	50
RC55OR1806	6/4	G1/8	6	25.5	22.5	12	14	14	50
RC55OR1406	6/4	G1/4	8	25	23.5	12	17	17	50
RC55OR1808	8/6	G1/8	6	22.5	23.5	14	14	14	50
RC55OR1408	8/6	G1/4	8	25	23.5	14	17	17	50
RC55OR1410	10/8	G1/4	8	25.5	23.5	14	17	17	50

### RC55F

#### GOMITO FEMMINA CILINDRICO BSPP

#### ELBOW FEMALE PARALLEL BSPP

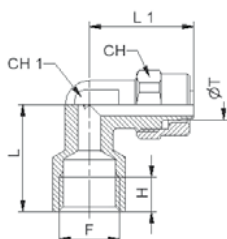

Codice/Code	ØT	F	H	L	L1	CH	CH1	
RC55F1805	5/3	R1/8	8	19	21.5	8	10	50
RC55F1806	6/4	R1/8	9	24	26	12	10	100
RC55F1406	6/4	R1/4	8	23	23	12	12	50
RC55F1808	8/6	R1/8	7	20	20.5	14	10	100
RC55F1408	8/6	R1/4	11	29	31	14	11	50
RC55F1410	10/8	R1/4	11	29	32	16	11	50
RC55F3812	12/10	R3/8	10	30.5	29	19	17	20

### RC56

#### L INTERMEDIO

#### L INTERMEDIATE

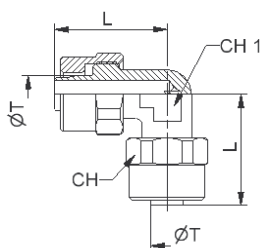

NEW

Codice/Code	ØT	L	CH	CH1				
RC560004	4/2,7	20.3	8	8				50
RC560005	5/3	21.5	8	8				50
RC560006	6/4	21.5	12	8				100
RC560008	8/6	22.5	14	10				100
RC560010	10/8	25.5	16	11				50
RC560012	12/10	30	18	14				20
RC560015	15/12,5	34	22	17				20

### RC57OR

#### T GIREVOLE CENTRALE MASCHIO CILINDRICO BSPP CON O-RING

#### CENTRAL T MALE ROTATING BODY PARALLEL BSPP WITH O-RING

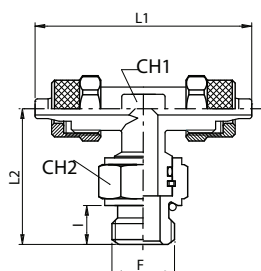

NEW

Codice/Code	D	D1	I	H	L	CH	CH1	CH2	
RC57OR1804	4/2,7	1/8	6	25,7	45	8	8	13	20
RC57OR1806	6/4	1/8	6	25,7	45	8	12	13	20
RC57OR1406	6/4	1/4	8	29	45,5	10	12	16	20
RC57OR1808	8/6	1/8	6	26	45,5	10	14	13	20
RC57OR1408	8/6	1/4	8	28	45,5	10	14	16	20
RC57OR1410	10/8	1/4	8	29	51	11	16	16	20

RC57K

T AL CENTRO CONICO BSPT

CENTRAL T TAPER BSPT

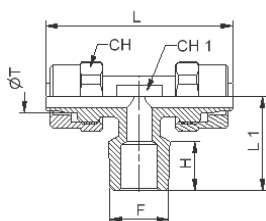

Codice/Code	ØT	F	H	L	L1	CH	CH1	
<b>NEW</b> RC57K1804	4/2,7	R1/8	8	40.5	17	8	8	50
RC57M505	5/3	M5	4	43	15	8	8	50
RC57K1805	5/3	R1/8	8	43	17	8	8	50
RC57K1806	6/4	R1/8	8	44	21	12	8	50
RC57K1406	6/4	R1/4	10.5	46	24	12	10	50
RC57K3806	6/4	R3/8	11.5	47	22.5	12	11	50
RC57K1808	8/6	R1/8	8	45	23	14	10	50
RC57K1408	8/6	R1/4	12.5	48	21	14	12	50
RC57K3808	8/6	R3/8	11.5	48	22.5	14	11	50
RC57K1810	10/8	R1/8	8	52	25	16	12	50
RC57K1410	10/8	R1/4	10.5	52	28	16	12	50
RC57K3810	10/8	R3/8	11.5	51	22.5	16	11	20
RC57K1210	10/8	R1/2	14	57	28	17	16	20
RC57K3812	12/10	R3/8	11.5	60	24.5	18	14	20
RC57K1212	12/10	R1/2	14	61	28	18	17	20
RC57K1215	15/12.5	R1/2	14	68	28	22	17	10

RC58K

T LATERALE CONICO BSPT

LATERAL T MALE TAPER BSPT

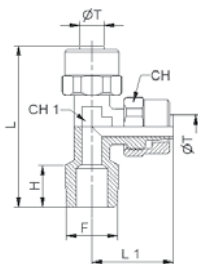

Codice/Code	ØT	F	H	L	L1	CH	CH1	
<b>NEW</b> RC58K1804	4/2,7	R1/8	8	38	21,5	8	8	8
<b>NEW</b> RC58M505	5/3	M5	4	36,5	21,5	8	8	8
<b>NEW</b> RC58K1805	5/3	R1/8	8	38,5	21,5	8	8	8
RC58K1806	6/4	R1/8	8	41	27	12	8	8
RC58K1406	6/4	R1/4	10.5	42	27	12	10	10
RC58K3806	6/4	R3/8	11,5	46,5	24	12	11	11
RC58K1808	8/6	R1/8	8	40,5	22,5	14	10	10
RC58K1408	8/6	R1/4	10.5	42	27	14	10	10
RC58K3808	8/6	R3/8	11,5	46,5	23,5	14	11	11
<b>NEW</b> RC58K1810	10/8	R1/8	8	44	25,5	16	11	11
RC58K1410	10/8	R1/4	10.5	48	32	16	12	11
RC58K3810	10/8	R3/8	11,5	48	25,5	16	11	11
RC58K1210	10/8	R1/2	14	57	29	16	17	17
<b>NEW</b> RC58K3812	12/10	R3/8	11,5	54,5	30	18	14	14
RC58K1212	12/10	R1/2	14	58,5	28	18	17	17
RC58K1215	15/12,5	R1/2	14	62	34	22	17	17

RC59

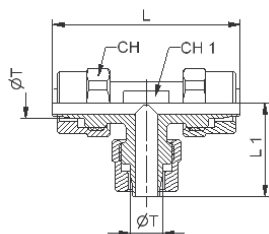

T INTERMEDIO

T INTERMEDIATE

Codice/Code	ØT	L	L 1	CH	CH 1			
<b>NEW</b> RC590004	4/2,7	40.6	20.3	8	8			50
RC590005	5/3	43	21.5	8	8			50
RC590006	6/4	45	22.5	12	8			50
RC590008	8/6	45	22.5	14	10			50
RC590010	10/8	51	25.5	16	11			20
RC590012	12/10	60	30	18	14			20
RC590015	15/12.5	68	34	22	17			10

RC60

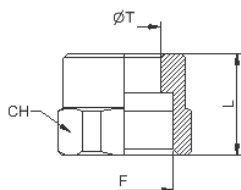

DADO

NUT

Codice/Code	ØT	F	L	CH				
RC600004	4/2.7	M6x0.5	8.1	8				100
RC600005	5/3	M7x0.75	8	8				100
RC600806	6/4	M8x0.75	9	9				100
RC601006	6/4	M10x1	10.5	12				100
RC600008	8/6	M12x1	10.5	14				100
RC600010	10/8	M14x1	11	16				100
RC600012	12/10	M16x1	13	18				100
RC600015	15/12.5	M20x1	15.5	22				50

RC61

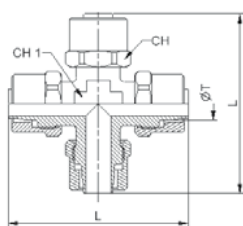

CROCE INTERMEDIO

CROSS INTERMEDIATE

Codice/Code	ØT	L	CH	CH 1				
RC610005	5/3	43	8	8				50
RC610006	6/4	45	12	8				50
RC610008	8/6	45	14	10				20
RC610010	10/8	51	16	11				20

RC62

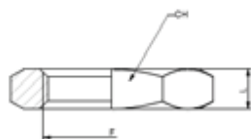

GHIERA

NUT

Codice/Code	F	L	CH					
RC6200M5	M5	2,5	9					100
RC620018	1/8"	3,5	12					100
RC620014	1/4"	4	16					100
RC620038	3/8"	4,5	19					50
RC620012	1/2"	4.5	24					50
RC620034	3/4"	5	30					20
RC620001	1"	6	38					20

RC65

BANJO SINGOLO

BANJO (SINGLE)

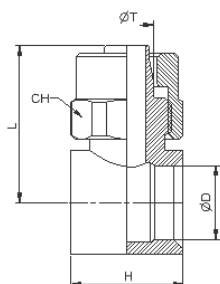

Codice/Code	ØT	ØD	H	L	CH			
RC65M504	4/2.7	M5	9	15.8	8			100
RC65M506	6/4	M5	9	18	9			100
RC651806	6/4	G1/8	14.5	24	12			100
RC651406	6/4	G1/4	14.5	26	12			100
RC651808	8/6	G1/8	14.5	24	14			100
RC651408	8/6	G1/4	14.5	26	14			50
RC651410	10/8	G1/4	14.5	27.5	16			50

RC66

BANJO DOPPIO

BANJO (DOUBLE)

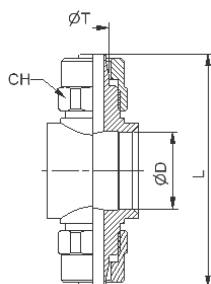

Codice/Code	ØT	ØD	L	CH				
RC661806	6/4	G1/8	48	12				100
*RC661406	6/4	G1/4	52	12				50
RC661808	8/6	G1/8	48	14				50
*RC661408	8/6	G1/4	52	14				50
*RC661410	10/8	G1/4	55	16				50

\* Articoli da assemblare con aste cod. AS875 . AS885  
\* Items used with steams AS875 . AS885

RC72

BANJO FILETTATO

FEMALE BANJO

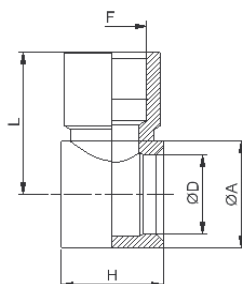

Codice/Code	F	ØD	H	ØA	L			
RC720018	G1/8	G1/8	15	14	20			50
RC720014	G1/4	G1/4	17	18	24			50
<b>NEW</b> RC720038	G3/8	G3/8	21		29			50